



The Goring

---

## EVENTS AT THE GORING



### *Beautifully appointed private spaces*

---

The Goring's private dining, meeting and event spaces are beautifully designed and provide an impeccably English backdrop to any occasion. Accommodating from just 4 to 100 guests, The Goring's delicious food and immaculate service ensure that everything runs like clockwork.



The Goring, Beeston Place, London, SW1W 0JW  
Tel: +44 (0) 20 7769 4555 Email: [privatedining@thegoring.com](mailto:privatedining@thegoring.com) [www.thegoring.com/events](http://www.thegoring.com/events)



# THE GARDEN ROOM

The Garden Room is the largest of The Goring's private rooms and has its own conservatory area with a sliding wall of glass leading out to The Goring Gardens. Guests have access to a private patio from which the gardens can be accessed, making it ideal for celebrations and weddings. The Garden Room is equipped with the latest technology including a fitted screen, projector and WiFi.

## THE GARDEN ROOM

Area size 10.3m x 8.3m /85.5m

Seats 44 for lunch or dinner

Seats 20 for boardroom set-up

Seats 50 for theatre set-up

Holds 100 for receptions

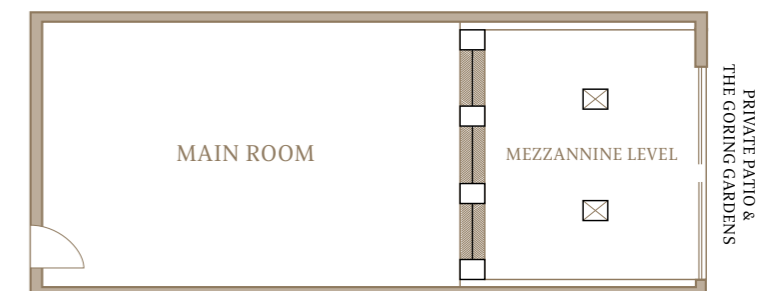

*Perfect for...* weddings, parties, receptions, meetings and celebrations.



The Goring, Beeston Place, London, SW1W 0JW  
 Tel: +44 (0) 20 7769 4555 Email: [privatedining@thegoring.com](mailto:privatedining@thegoring.com) [www.thegoring.com/events](http://www.thegoring.com/events)



BRING *great minds* TOGETHER

## THE BOARDROOM

Tucked away on the fourth floor, The Boardroom is all about discretion and not being disturbed. Ideal for smaller business meetings, it is bathed in natural daylight and striking in design, with comfortable leather chairs and state-of-the-art technology.

### THE BOARDROOM

Area size 4.4m x 4.2m / 8.5m

Seats 8 for lunch or dinner (buffet only)

Seats 8 for boardroom set-up

Not available for theatre set-up

Not available for receptions

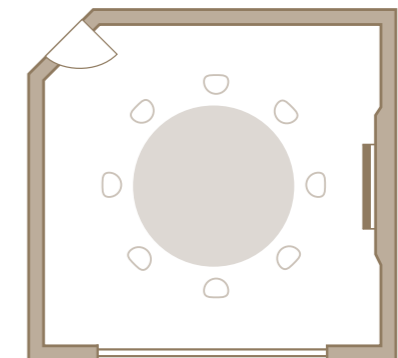

*Perfect for...* perfect for meetings, interviews and presentations.



The Goring, Beeston Place, London, SW1W 0JW  
Tel: +44 (0) 20 7769 4555 Email: [privatedining@thegoring.com](mailto:privatedining@thegoring.com) [www.thegoring.com/events](http://www.thegoring.com/events)

SET *the scene* IN ELEGANT SURROUNDINGS



## THE DRAWING ROOM

The Drawing Room has recently been refurbished and transformed with the most intricate woven wallpaper, giving the room the relaxed sophistication of a grand English country house or a chic private city residence. Located on the ground floor, it is perfect for a private dinner or business meeting. Comfortably seating up to 12 guests, The Drawing Room is flooded with natural daylight and features a discreet 55" plasma screen concealed behind an antique mirror – making it perfect for work or play.

### DRAWING ROOM

Area size 5.9m x 4.6m / 27m

Seats 12 for lunch or dinner

Seats 12 for boardroom set-up

Seats 20 for theatre set-up

Holds 25 for receptions

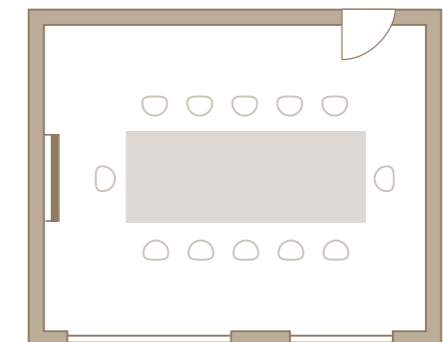

*Perfect for...* private parties, presentations, meetings or a memorable reward for your team.



The Goring, Beeston Place, London, SW1W 0JW  
Tel: +44 (0) 20 7769 4555 Email: [privatedining@thegoring.com](mailto:privatedining@thegoring.com) [www.thegoring.com/events](http://www.thegoring.com/events)



## THE SILVER ROOM

The most intimate of The Goring's private rooms is The Silver Room, which has also undergone a sumptuous renovation with stunning new wallpaper. This light-filled room is adjacent to The Dining Room and up to 8 guests can enjoy a lavish Michelin-starred lunch or dinner under the sparkle of the Edwardian chandelier.

### SILVER ROOM

Area size 4.2m x 3.4m / 14m

Seats 8 for lunch or dinner

Seats 7 for boardroom set-up

Not available for theatre set-up

Not available for receptions

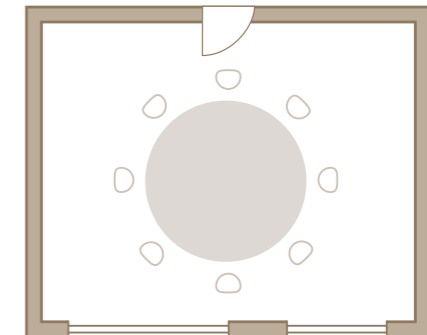

*Perfect for...* breakfast, lunch, dinner and smaller meetings.



The Goring, Beeston Place, London, SW1W 0JW  
Tel: +44 (0) 20 7769 4555 Email: [privatedining@thegoring.com](mailto:privatedining@thegoring.com) [www.thegoring.com/events](http://www.thegoring.com/events)



THE PROUD OWNERS *of a* MICHELIN STAR

## MICHELIN-STARRED DINING

---

The Goring offers stunning yet relaxed dining spaces that are popular with locals and guests alike. The private dining rooms are impeccably managed by Mikko Jappinen and they provide exceptional settings for any occasion with Michelin-starred food from Executive Chef Shay Cooper and an extensive wine list curated by Head Sommelier Olivier Clause.



The Goring, Beeston Place, London, SW1W 0JW  
Tel: +44 (0) 20 7769 4555 Email: [privatedining@thegoring.com](mailto:privatedining@thegoring.com) [www.thegoring.com/events](http://www.thegoring.com/events)

## ROOM SPECIFICATIONS

---

PRIVATE ROOM	AREA SQ. M	LUNCH OR DINNER	BOARDROOM	THEATRE	RECEPTION	SIZE METRES
The Garden Room	86m	44	20	50	100	10.3m x 8.3m
The Drawing Room	27m	12	12	20	25	5.9m x 4.6m
The Silver Room	14m	8	7	N/A	N/A	4.2m x 3.4m
The Boardroom	19m	8	8	N/A	N/A	4.4m x 4.2m



## SPEND THE NIGHT

---

*Don't rush your day...*

Book an overnight stay at The Goring the day before or the evening of your event to make the occasion all the more memorable.

Contact [reservations@thegoring.com](mailto:reservations@thegoring.com) for exclusive rates.

---

EXPLORE OUR ROOMS AND SUITES

---

## BOOK YOUR EVENT

---

Our experienced Events & Private Dining Team can help to perfectly plan your event and to meet even the most specific of requirements. To book any one of our beautiful spaces for your meeting or special occasion, please call on 020 7769 4555 or email [privatedining@thegoring.com](mailto:privatedining@thegoring.com)

[WWW.THEGORING.COM](http://WWW.THEGORING.COM)



  
 The Goring, Beeston Place, London, SW1W 0JW  
 Tel: +44 (0) 20 7769 4555 Email: [privatedining@thegoring.com](mailto:privatedining@thegoring.com) [www.thegoring.com/events](http://www.thegoring.com/events)